

NOV 3242F – DUAL Construction Hoist

SPECIFICATIONS

CAPACITY & WEIGHT

Load Capacity w/o counterweight	7,200 lb (3,270 kg)
Load Capacity w/ counterweight	8,000 lb (3,600 kg)
Standard Lifting Speed	230 fpm (1.17 m/s)
Base Unit Weight	12,200 lb (5,545 kg)
Car Weight - Each	4,850 lb (2,200 kg)
Tower Weight (5' section)	440 lb (200 kg)
Configuration	Dual

DIMENSIONS

Car Interior Width	4'-10 7/8" (1.5 m)
Car Interior Length	13' - 6 1/8" (4.12 m)
Car Interior Height*	8' 1/2" (2.45 m)
End Door Opening	4'-10 7/8" (1495 mm) x 7' 1/2" (2150 mm)
"C" Car Door Opening	10'-6 3/8" (3210 mm) x 6'-10" (2100 mm)
Wall Tie Spacing	30' Maximum

DRIVE DETAILS

Power Required	480 V, 3 PHASE, 60 HZ
Motor	3 x 20 HP (15 kW)
Variable Frequency Controller	(90 kW)
Full Load Current - Each Car	2X 135 A
Required Disconnect - Each Car	2X 150 A
Lighting Circuit	110 V, 1 Phase, 60 Hz
Power Cable Guide System	Cable Trolley & Guides
Brake	Spring-Set Multi-disc brake



DETAILS

- Fully Assembled Enclosed Car
- Roof-Mounted Industrial Drive System
- Variable Frequency Motor Control
- Painted Mesh Upper Walls
- Marine Grade Aluminum Lower Walls
- Robust Painted Floor, Roof & Frame
- Anti-Slip Painted Floor
- Bi-Swing Landing Doors
- Galvanized Rooftop Handrails
- NEMA 4X Stainless Electrical Enclosures
- Rooftop Inspection Station
- Over Speed Safety Governor
- Manual Lowering
- Two Vertically Bi-Parting Door
- Manual Hand Lever Control
- Base Fence Enclosure w/ Bi-Parting Door
- Power Cable
- Power Cable Trailing Wheel & Guides
- Interior Car Lighting
- Interlocked Roof Hatch & Convenience Ladder
- Base Frame & 20' (6.1 m) Galvanized Tower
- Base-Level Buffers & Galvanized Buffer Stand

FOUNDATION INFORMATION

- Recommended foundation is 10" thick, 4,000 psi concrete pad with #5 rebar on 10" centers located 3" from bottom.
- Assumes compacted soil of 2,000 psf

OPTIONS

- Base Landing Platform & Stairs
- Base Power Disconnect (480V)
- Counterweight
- Custom Coatings & Materials
- Explosion Proof
- Erection Crane
- Automatic Control
- Various Landing & Car Door Configurations

NOV 3242F – DUAL Construction Hoist

ADDITIONAL INFORMATION

- Code Compliance: ANSI A10.4
- The car and hoistway dimensions are only for information, the sizes can be changed to meet the customer requirements.
- Use of products must conform to safe practice and applicable statutes, regulations, codes and ordinances.
- Drawings and components are illustrative only and do not necessarily depict exact configurations of products offered at a particular time.
- *The car interior is 8'2" but there are some ceiling area obstructions at 7'11".
- Loading height is 4'7" above top of foundation.

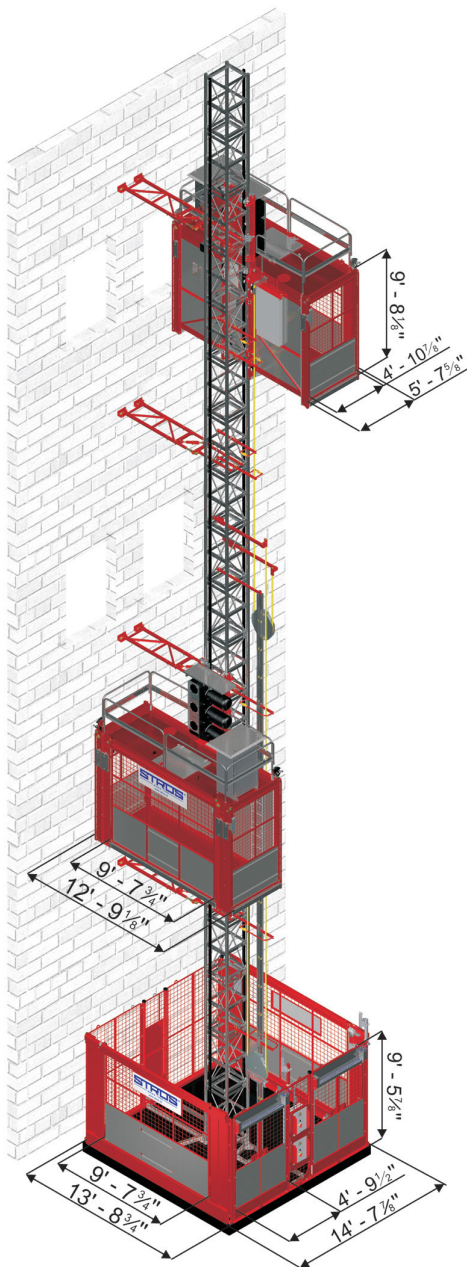

Plan View "S" Mast

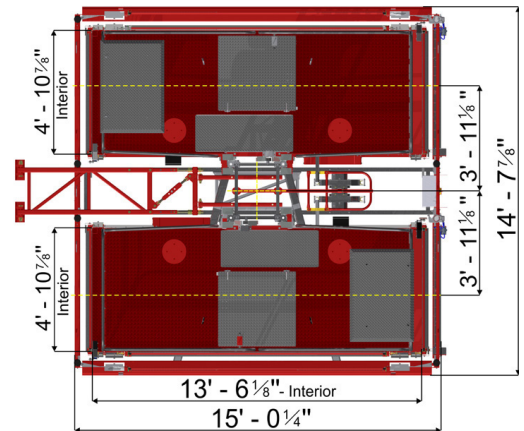

Face Mount

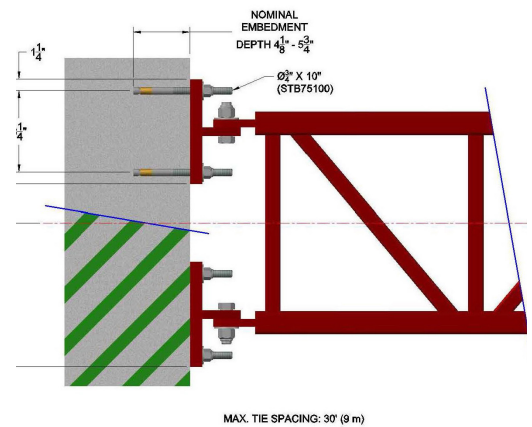

Top Mount

